

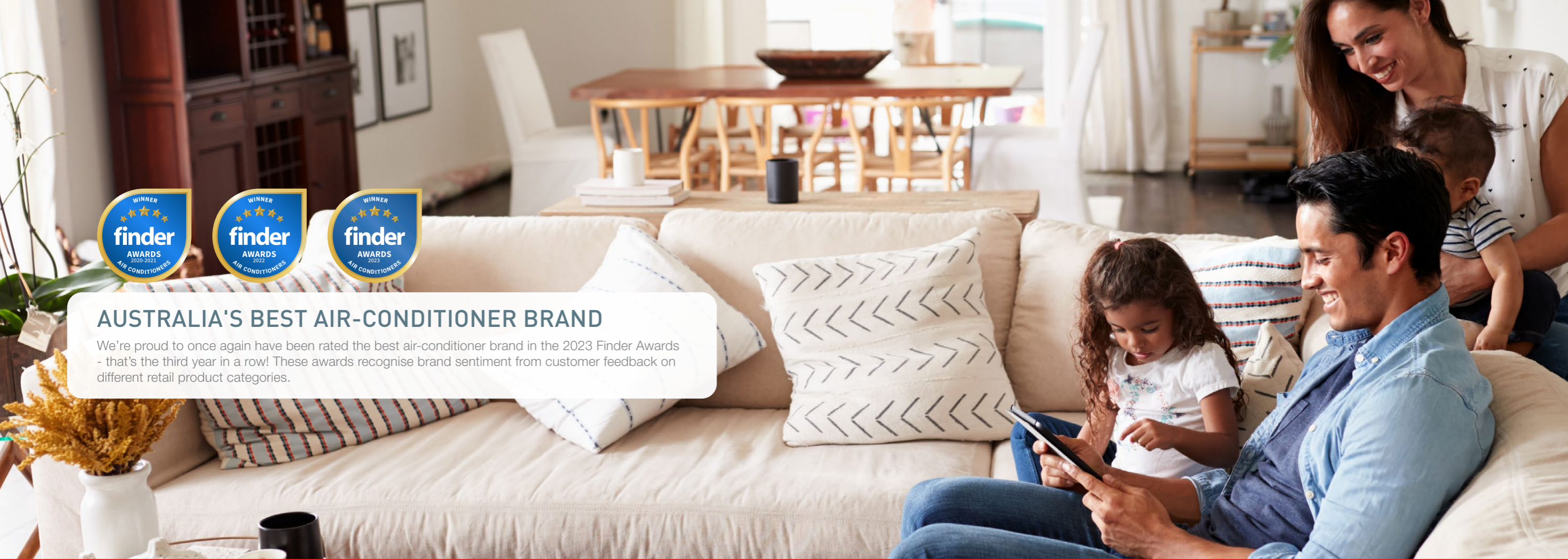

HEATING AND COOLING SOLUTIONS

**MULTI-SPLIT SYSTEMS**



## AUSTRALIA'S BEST AIR-CONDITIONER BRAND

We're proud to once again have been rated the best air-conditioner brand in the 2023 Finder Awards - that's the third year in a row! These awards recognise brand sentiment from customer feedback on different retail product categories.

## MITSUBISHI HEAVY INDUSTRIES AIR CONDITIONERS AUSTRALIA

Mitsubishi Heavy Industries Air-Conditioners Australia (MHIAA) is one of Australia's leading suppliers of premium residential and commercial air conditioning systems. Delivering engineering excellence for over 130 years, the Mitsubishi Heavy Industries brand is instantly recognisable for quality and technological advancement.

With innovation central to both the organisation and the development of air conditioning systems, Mitsubishi Heavy Industries carries a strong philosophy of engineering products that are designed to improve the lives of those who use them and at the same time, create a sustainable future for our company and the world we live in.

## COMMITTED TO QUALITY

Standing behind the quality of our products, is our commitment to our customers and our after sales service guarantees. Along with the rigorous quality assurance testing carried out on all Mitsubishi Heavy Industries products, comprehensive warranties provide you with peace of mind and carry our commitment to quality.

## 5 YEARS PARTS AND LABOUR WARRANTY

Mitsubishi Heavy Industries Air conditioners Australia focuses solely on manufacturing high performance air conditioners for the Australian market. All our systems are of the highest quality and are backed by a full 5 year parts and labour warranty.



## EXCEEDING ENERGY PERFORMANCE STANDARDS

To comply with Australian standards and deliver the most efficient solutions possible to our customers, all Mitsubishi Heavy Industries Air conditioners Australia systems meet and exceed the Minimum Energy Performance Standards (MEPS).



# MHIAA Multi-Split Systems

Mitsubishi Heavy industries multi-split systems use state of the art, advanced technologies to create the perfect heating and cooling solution for residential and commercial applications.

Characterised by high flexibility, high energy efficiency and reduced noise levels, the innovative multi-split systems can be designed and tailored to suit your specific needs, providing the ultimate in-home comfort across several rooms.

## DESIGN FLEXIBILITY

Mitsubishi Heavy industries multi-split systems allow between 2 to 5\* indoor units to be connected to 1 single outdoor unit. This flexibility offers an energy efficient and space saving solution for heating and cooling multiple rooms using multiple product combinations.

## INDIVIDUAL ROOM CONTROL

To provide maximum comfort, users can individually control each indoor unit. This includes controlling when each unit is turned on or off, changing the temperature, adjusting settings, and switching on/off features and functions.

## ENERGY EFFICIENCY

With the ability to select which indoor unit will operate, multi-split systems offer an energy saving solution that can help reduce running costs.

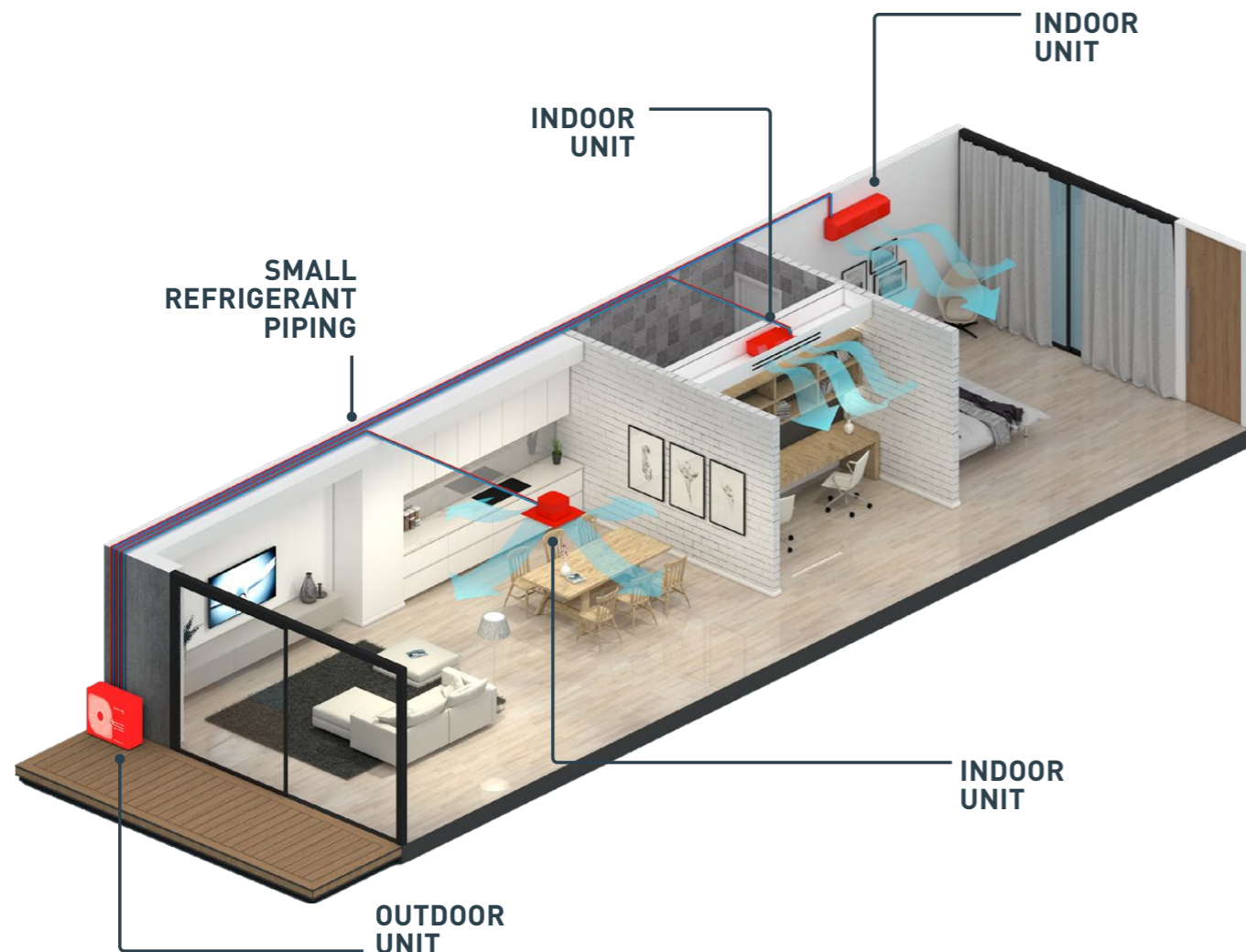

# SCM Series

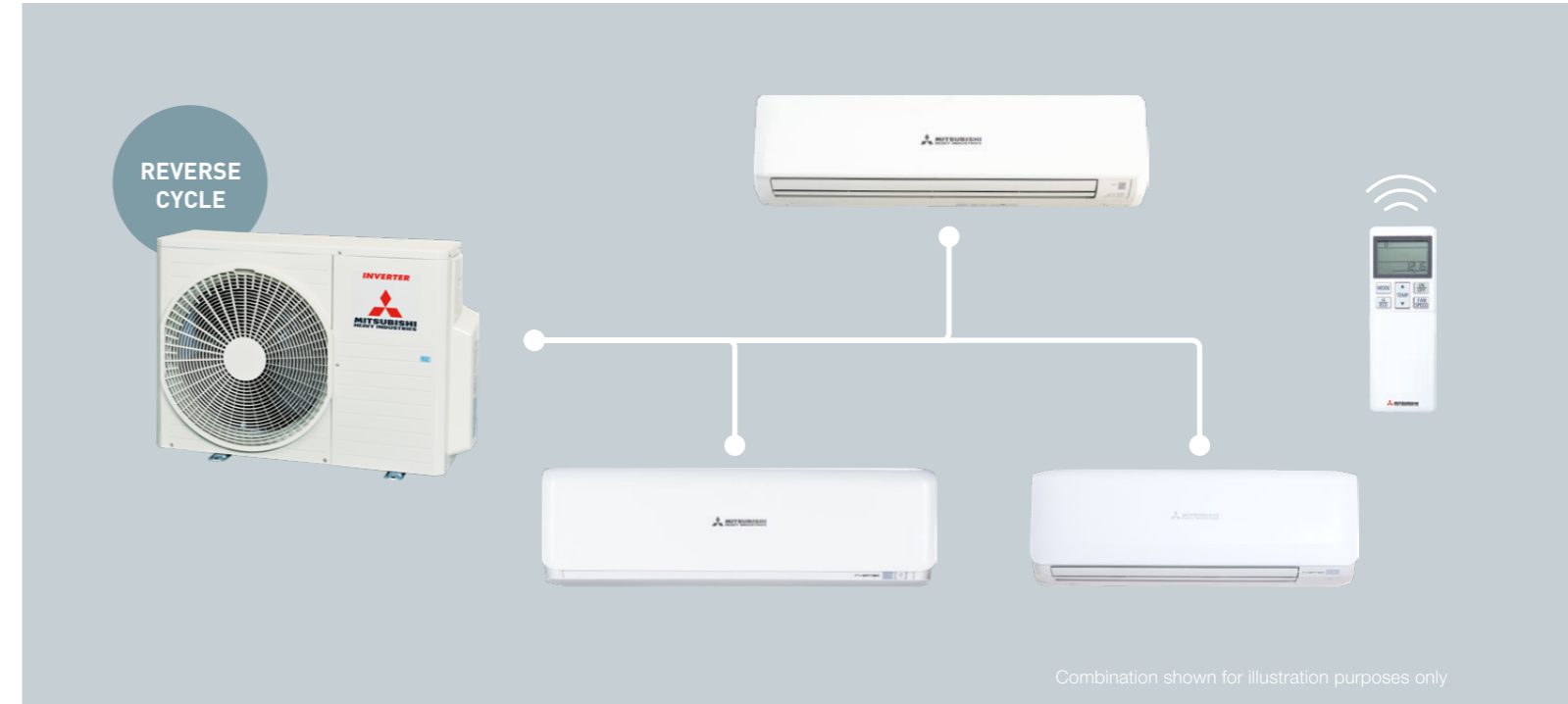

## 4kW | 4.5kW | 5kW | 6kW | 7.1kW | 8kW | 10kW

The SCM series of multi-split system outdoor units delivers an efficient and flexible solution for heating and cooling multiple rooms. Ranging from 4kW up to 10kW, the SCM series can be connected to up to 5 indoor units.

SCM-ZS-W		SCM40ZS-W	SCM45ZS-W	SCM50ZS-W
Cooling Capacity	kW	4.0 (1.5~5.9)	4.5 (1.5~6.4)	5.0 (1.7~7.1)
Heating Capacity		4.5 (1.0~6.3)	5.3 (1.0~6.5)	6.0 (1.0~7.5)
Max Indoor Unit Connection		2 units	2 units	2 to 3 units

SCM-ZS-W		SCM60ZS-W	SCM71ZS-W	SCM80ZS-W	SCM100ZS-W
Cooling Capacity	kW	6.0 (1.7~7.5)	7.1 (1.8~8.8)	8.0 (1.8~9.2)	10.0 (1.7~11.5)
Heating Capacity		6.8 (1.0~7.8)	8.6 (1.1~9.4)	9.3 (1.1~9.8)	10.5 (0.9~11.5)
Max Indoor Unit Connection		2 to 3 units	2 to 4 units	2 to 4 units	*3 to 5 units

\* This model normally requires a minimum of 3 indoor units. combination of 2 indoor units in some circumstances would be permitted. Please refer to the "combination Limitations" for the detailed connection information

# Legal Combinations/Limitations

		INDOOR UNITS																													
		Wall Mounted					Floor Mount			Bulkhead				Compact Cassette				Mid-Static Ducted													
Outdoor Model Number	Image	Number of Indoor Units to Be Connected	Minimum Connection Capacity (kW)	Maximum Connection Capacity (kW)	Type Model Number Capacity (kW)	SRK-ZSA-W					SRK-ZSXA-W					SRK-ZRA-W		SRF-ZS(X)-W			SRR-ZS-W				FDTC-VH				FDUM-VH		
						2.0	2.5	3.5	5.0	2.0	2.5	3.5	5.0	6.0	7.1	8.0	2.5	3.5	5.0	2.5	3.5	5.0	6.0	2.5	3.5	5.0	6.0	5.0			
SCM40ZS-W		2	4.0	6.0		■	■	■		■	■	■						■	■		■	■			■	■					
SCM45ZS-W		2	4.5	7.0		■	■	■		■	■	■						■	■		■	■			■	■					
SCM50ZS-W		2 to 3	5.0	8.5		■	■	■	■	■	■	■						■	■	■	■	■	■			■	■	■		■	
SCM60ZS-W		2 to 3	6.0	11.0		■	■	■	■	■	■	■	■					■	■	■	■	■	■	■			■	■	■		■
SCM71ZS-W		2 to 4	7.0	12.5		■	■	■	■	■	■	■	■		■				■	■	■	■	■	■	■			■	■		■
SCM80ZS-W		2 to 4	8.0	13.5		■	■	■	■	■	■	■	■		■				■	■	■	■	■	■	■			■	■		■
SCM100ZS-W		3 to 5	9.0	16.0		■	■	■	■	■	■	■	■		■		■		■	■	■	■	■	■	■			■	■		■

## SCM100ZS-W Indoor Unit Combination Limitations

		INDOOR UNITS																													
Outdoor Model Number	Indoor Units Connected	Possible Combinations	Type Model Number Capacity (kW)	Wall Mounted					Floor Mount			Bulkhead				Compact Cassette				Mid-Static Ducted											
				SRK-ZSA-W					SRK-ZSXA-W					SRK-ZRA-W		SRF-ZS(X)-W			SRR-ZS-W				FDTC-VH				FDUM-VH				
				2.0	2.5	3.5	5.0	2.0	2.5	3.5	5.0	6.0	7.1	8.0	2.5	3.5	5.0	2.5	3.5	5.0	6.0	2.5	3.5	5.0	6.0	5.0					
*SCM100ZS-W	2	2 x SRK-ZSXA-W or 1 x SRK-ZSXA-W + 1 x SRF35ZS-W or 1 x SRK-ZSXA-W + 1 x SRF50ZSX-W. includes 1 or more SRK71,80ZRA-W					■	■	■	■	■		■		■				■	■	■										
	3	No Limitation	■	■	■	■	■	■	■	■	■	■	■		■				■	■	■	■	■	■	■			■	■		■
	4	No Limitation	■	■	■	■	■	■	■	■	■	■	■		■				■	■	■	■	■	■	■			■	■		■
	5	A) SRK-ZSXA-W, SRF35ZS-W, SRF50ZSX-W must be 4 or less. B) When connecting 14.6 to 16.0 kW, refer below.	■	■	■	■	■	■	■	■	■	■	■							■	■	■	■	■	■			■	■		■

\*This model normally requires, a minimum of 3 indoor units and total indoor units connection capacity is from 9.0kW - 16.0kW  
**A)** 5 units can be connected by connecting other indoor units. example: SRK-ZSXA-W x 4 + SRK-ZSA-W x 1  
**B)** Combination of indoor units that are not Possible are: 20 + 20 + 20 + 20 + 71 | 20 + 20 + 20 + 20 + 80 | 20 + 20 + 20 + 25 + 71 | 20 + 20 + 20 + 50 + 50  
 When connection is from 14.6kW - 16.0kW, the sum of the coefficients is to be 6 or less: 20, 25, 35 = 1. 50, 60 = 2. 71, 80 = 3  
 Note: SRK63ZRA-W, SRK95ZRA-W and other FDUM models cannot be connected to SCM100ZS-W

# Optional Control Solutions



## RC-EXZ3A WIRED CONTROLLER

- Large, 3.8" backlit LCD touch screen with easy to navigate menu.
- Control the set temperature, operation mode and fan speed.
- Access timer and scheduling functions.
- Access additional features including Home Leave mode, Silent Mode, High Power mode plus more.
- Multi-language display (6 languages)

\*\*Requires SC-BIKN2-E kit (sold separately) for use with wall mounted, bulkhead and floor standing systems. \*\*\*Function limitations may apply.



## WIRELESS CONTROLLER

- LCD Display.
- Control the set temperature, operation mode and fan speed.
- Access timer and scheduling functions.

\*Wireless controller from RCN-KIT4-E2 shown. Standard with bulkhead systems.  
 \*\*Requires RCN-KIT4-E2 wireless kit (sold separately) for use with ducted systems.  
 \*\*\*Function limitations may apply.



## WI-FI SOLUTION

- Control your system using your smart device (iPhone, iPad, Android) via the AC Cloud Control app or internet browser
- Control the set temperature, operation mode and fan speed remotely.
- Control your system using Voice Command via your Google or Amazon smart speaker device.
- Set up 'favourite' scenes and activate them with a single tap.
- Set your system to respond to the weather, you arriving home, calendar events + more\*\*.
- Receive instant notifications and email updates\*\*

\*Requires MH-AC-WIFI-1 Wi-Fi adaptor for use with split systems & MH-RC-WIFI-1B adaptor for use with ducted and ceiling systems (both sold separately).  
 \*\*In conjunction with IFTTT and other apps (must be downloaded separately). Some additional functions may not be available via AC Cloud Control app. The system's On/Off timer, weekly timer and sleep timer are disabled if a Wi-Fi accessory is connected. Similar functions can be set via the AC Cloud App.

	INDOOR UNITS						
	SRK-ZSA	SRK-ZSXA	SRF-ZS(X)	SRK-ZRA	SRR-ZS	FDUM	FDTC
<b>WIRED CONTROLLER (OPTIONAL)</b>							
<b>OPTIONAL</b>							
RC-EXZ3A / RC-E5	■	■	■	■	■	■	■
RCH-E3	■	■	■	■	■	■	■
<b>WIRELESS CONTROLLER</b>							
<b>ACCESSORY</b>							
RCN-TC-5AW-E3	■	■	■	■	■		
<b>OPTIONAL (REQUIRES WIRELESS KIT)</b>							
RCN-KIT4-E2						■	■
<b>WI-FI KIT</b>							
<b>OPTIONAL</b>							
MH-AC-WIFI-1	■	■	■	■	■		
MH-RC-WIFI-1B						■	■

NOTE: Central control and BMS control options are available. Please contact Mitsubishi Heavy Industries for more information. For installation of wired remote controllers to SRK and SRR units an additional SC-BIKN2-e kit is required.

# Wi-Fi Solution

## VOICE COMMAND CONTROL

Your MHI air-conditioner can now be connected with any Alexa-enabled or Google Assistant voice control device. Turn your air-conditioner on or off, change the operation mode or set the temperature using just your voice!



## SMART DEVICE CONTROL

Turn your air-conditioner on, check the temperature while you're out and about. Can't remember if you turned your air-conditioner off? Easily check and turn your unit off remotely using your smart device.

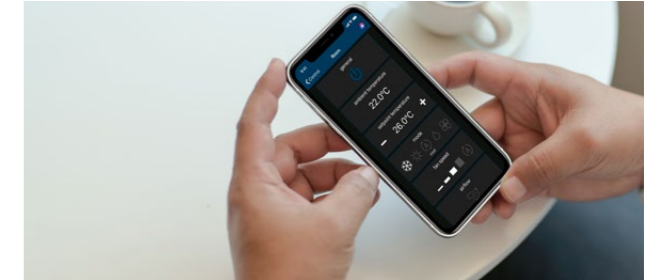

## SMART HOME INTEGRATION

Tap into a universe of IFTTT (If This Then That) recipes and turn your MHI system into a smart air-conditioner. IFTTT app allows to easily connect your air-conditioner to 3rd party applications, services and devices including Gmail, Calendars, Weather, smartwatches plus thousands more, giving your unit advanced, smart functionality.



- Set your air-conditioner to turn on when you get close to home.
- Set your air-conditioner to turn on or off depending on the weather outside.
- Set your air-conditioner to turn on from the moment you wake up.

## AC Cloud Control



### Compatible with



Controlling your device with AC Cloud Control app requires aforementioned Wi-Fi adaptors and working internet or Wi-Fi connection. Google Account required for use with Google devices. Features and services may change without notice. Google is a trademark of Google LLC.

# OUTDOOR UNIT LIMITATION SUMMARY

CAPACITY	SCM40ZS-W	SCM45ZS-W	SCM50ZS-W	SCM60ZS-W	SCM71ZS-W	SCM80ZS-W	SCM100ZS-W
Number of connectable indoor units	2		2 to 3		2 to 4		*3 to 5
Maximum capacity of indoor units allowable (kW)	6	7	8.5	11	12.5	13.5	16
Length for one indoor unit (m)				25			
Total length for all rooms (m)	30		40		70		75
Height Difference (m)	Outdoor unit is above	15				20	
	Outdoor unit is below	15				20	
Maximum height difference of the indoor units			25				
Pre-charged to refrigerant pipe length (m)	20		40		30		40
Outdoor air temperature (upper, lower limits)	Cooling						-15 to 46
	Heating						-15 to 24

This model normally requires a minimum of 3 indoor units. Combination of 2 indoor units in some circumstances would be permitted. Please refer to the "combination limitations" table on page 10 for the detailed connection information

Item	Indoor Air Temperature		Outdoor Air Temperature		Standards
	DB	WB	DB	WB	
Operation					
Cooling	27°C	19°C	35°C	24°C	AS/NZ 3823.2
Heating	20°C	-	7°C	6°C	

- (1) The data is measured at the conditions mentioned in the table to the left.
- (2) The air conditioner is manufactured and tested in conformity with the AS/NZS.
- (3) Sound level indicates the value in an anechoic chamber. During operation these values are somewhat higher due to ambient conditions.
- (4) Select the breaker size according to applicable national standard.
- (5) The operation data indicates when the air-conditioner is operated at 240V 50Hz.

\*Product specifications are accurate at time of printing and may be subject to updates.

## PRODUCT SPECIFICATIONS

# SCM SERIES

OUTDOOR UNIT	SCM40ZS-W	SCM45ZS-W	SCM50ZS-W	SCM60ZS-W	SCM71ZS-W	SCM80ZS-W	SCM100ZS-W
Power Source (Outdoor Unit)				1 Phase 240V 50Hz			
Nominal Capacity (Range)	Cooling T1	4.0 (1.5-5.9)	4.5 (1.5-6.4)	5.0 (1.7-7.1)	6.0 (1.7-7.5)	7.1 (1.8-8.8)	8.0 (1.8-9.2)
	Heating H1	4.5 (1.0-6.3)	5.3 (1.0-6.5)	6.0 (1.0-7.5)	6.8 (1.0-7.8)	8.6 (1.1-9.4)	9.3 (1.1-9.8)
Power Consumption	Cooling T1	0.80	0.96	1.02	1.32	1.42	1.70
	Heating H1	0.83	1.06	1.16	1.40	1.75	1.95
Running Current	Cooling T1	3.4	4.1	4.3	5.6	6.0	7.2
	Heating H1	3.5	4.5	4.9	5.9	7.4	8.2
Inrush Current, Maximum Current		3.7, 14	4.7, 14	5.15	5.15	5.20	5.20
		5.00	4.69	4.90	4.55	5.00	4.71
*Operation Data	EER	5.42	5.00	5.17	4.86	4.91	4.77
	GOP	62	63	62	62	63	66
Sound Power Level (JIS C9612)	Heating H1	64	65	64	64	67	67
	Cooling T1	49	50	49	50	50	54
Sound Pressure Level (JIS C9612)	Heating H1	51	52	52	52	54	54
	Cooling T1	44	44	43	43	45	46
Silent Mode	Heating H1	46	46	44	44	50	50
		595x780(+90)x290	595x780(+90)x290	640x850(+65)x290	640x850(+65)x290	750x880(+73)x340	750x880(+73)x340
External dimensions (HXWxD)	mm	40	40	48.5	48.5	61	61
	kg	1.4	1.4	1.8	1.8	2.55	2.55
Refrigerant (Type, Amount, Pre-charge Length)	Quantity	20	20	40	40	30	30
	Pre-Charged to Pipe	Ø6.35 (1/4") x 2	Ø6.35 (1/4") x 2	Ø6.35 (1/4") x 3	Ø6.35 (1/4") x 3	Ø6.35 (1/4") x 4	Ø6.35 (1/4") x 4
Installation Data	Liquid line	Ø9.52 (3/8") x 2	Ø9.52 (3/8") x 2	Ø9.52 (3/8") x 3	Ø9.52 (3/8") x 3	Ø9.52 (3/8") x 4	Ø9.52 (3/8") x 4
	Gas line	25	25	25	25	25	25
Connection Method	Maximum Pipe Length to One Indoor Unit	15 (O.U. above I.U.) / 15 (O.U. below I.U.)	15 (O.U. above I.U.) / 15 (O.U. below I.U.)	20 (O.U. above I.U.) / 20 (O.U. below I.U.)	20 (O.U. above I.U.) / 20 (O.U. below I.U.)	20 (O.U. above I.U.) / 20 (O.U. below I.U.)	20 (O.U. above I.U.) / 20 (O.U. below I.U.)
	Total Pipe Length to All Indoor Units	2.0, 2.5, 3.5	2.0, 2.5, 3.5	2.0, 2.5, 3.5, 5.0	2.0, 2.5, 3.5, 5.0	2.0, 2.5, 3.5, 5.0	2.0, 2.5, 3.5, 5.0
Max vertical height diff. between O.U. and I.U.	2.0, 2.5, 3.5	2.0, 2.5, 3.5	2.0, 2.5, 3.5, 5.0	2.0, 2.5, 3.5, 5.0, 6.0	2.0, 2.5, 3.5, 5.0, 6.0	2.0, 2.5, 3.5, 5.0, 6.0	2.0, 2.5, 3.5, 5.0, 6.0
	2.0, 2.5, 3.5	2.0, 2.5, 3.5	2.0, 2.5, 3.5, 5.0	2.0, 2.5, 3.5, 5.0, 6.0	2.0, 2.5, 3.5, 5.0, 6.0	2.0, 2.5, 3.5, 5.0, 6.0	2.0, 2.5, 3.5, 5.0, 6.0
Indoor Unit Combination	SRK-ZSA-W	2.5, 3.5	2.5, 3.5	2.5, 3.5, 5.0	2.5, 3.5, 5.0	2.5, 3.5, 5.0	2.5, 3.5, 5.0
	SRK-ZSXA-W	2.5, 3.5	2.5, 3.5	2.5, 3.5, 5.0	2.5, 3.5, 5.0	2.5, 3.5, 5.0	2.5, 3.5, 5.0
Indoor Unit Connection	SRK-ZFA-W	2.5, 3.5	2.5, 3.5	2.5, 3.5, 5.0	2.5, 3.5, 5.0	2.5, 3.5, 5.0	2.5, 3.5, 5.0
	SRR-ZS(X)-W	2.5, 3.5	2.5, 3.5	2.5, 3.5, 5.0	2.5, 3.5, 5.0	2.5, 3.5, 5.0	2.5, 3.5, 5.0
Indoor Connection Capacity	SRR-ZS-W	2 Units	2 Units	2 to 3 Units	2 to 3 Units	2 to 4 Units	**3 to 5 Units
	FDTC-VH	4.0 to 6.0	4.5 to 7.0	5.0 to 8.5	6.0 to 11.0	7.0 to 12.5	8.0 to 13.5
Outdoor air temperature (upper, lower limits)	Cooling	4.0 to 6.0	4.5 to 7.0	5.0 to 8.5	6.0 to 11.0	7.0 to 12.5	8.0 to 13.5
	Heating	-15 to 24	-15 to 24	-15 to 24	-15 to 24	-15 to 24	-15 to 24

\* Operation data has been gathered in accordance with AS/NZS 3823 standards. For testing conditions please refer to Page 10.

# SRK-ZSA & SRK-ZSXA SERIES

SRK-ZSA-W			
CAPACITY		2.0kW	2.5kW
Model Number		SRK20ZSA-W	SRK25ZSA-W
Cooling capacity	kW	2.0	2.5
Heating capacity		3.0	3.4
*Sound power level	dB(A)	49	53
		54	60
*Sound pressure level	dB(A)	Hi: 35 Me: 27 Lo: 22 UL: 19	Hi: 40 Me: 34 Lo: 27 UL: 19
		Hi: 39 Me: 30 Lo: 24 UL: 19	Hi: 46 Me: 38 Lo: 24 UL: 19
		Hi: 165 Me: 127 Lo: 93 UL: 93	Hi: 192 Me: 140 Lo: 88 UL: 78
Airflow	Indoor	Hi: 190 Me: 142 Lo: 108 UL: 93	Hi: 237 Me: 182 Lo: 110 UL: 88
Exterior dimensions (HxWxD)	mm	290x870x230	
Net weight	kg	10	
Clean Filter	Liquid line	Allergen Clear Filter x 1, Photocatalytic Washable Deodorizing Filter x 1	
	Gas line	Ø6.35 (1/4")	
Piping		Ø9.52 (3/8")	
OUTDOOR UNITS TO BE COMBINED		SCM40,45,50,60,71,80, 100ZS-W	
		Ø12.7 (1/2")	
		SCM50,60,71,80,100ZS-W	

SRK-ZSXA-W						
CAPACITY		2.0kW	2.5kW	3.5kW	5.0kW	6.0kW
Model		SRK20ZSXA-W	SRK25ZSXA-W	SRK35ZSXA-W	SRK60ZSXA-W	SRK60ZSXA-W
Cooling capacity	kW	2.0	2.5	3.5	5.0	6.0
Heating capacity		3.0	3.4	4.5	5.8	6.8
*Sound power level	dB(A)	53	55	58	59	62
		55	56	58	62	63
*Sound pressure level	dB(A)	Hi: 38 Me: 31 Lo: 24 UL: 19	Hi: 39 Me: 33 Lo: 25 UL: 19	Hi: 43 Me: 35 Lo: 26 UL: 19	Hi: 44 Me: 39 Lo: 31 UL: 22	Hi: 48 Me: 41 Lo: 33 UL: 22
		Hi: 38 Me: 30 Lo: 25 UL: 19	Hi: 40 Me: 34 Lo: 27 UL: 19	Hi: 42 Me: 35 Lo: 28 UL: 19	Hi: 46 Me: 41 Lo: 33 UL: 23	Hi: 47 Me: 42 Lo: 34 UL: 23
		Hi: 188 Me: 152 Lo: 100 UL: 83	Hi: 203 Me: 167 Lo: 112 UL: 83	Hi: 218 Me: 180 Lo: 122 UL: 83	Hi: 238 Me: 207 Lo: 130 UL: 90	Hi: 272 Me: 223 Lo: 148 UL: 90
Airflow	Indoor	Hi: 203 Me: 172 Lo: 120 UL: 90	Hi: 213 Me: 183 Lo: 130 UL: 90	Hi: 232 Me: 197 Lo: 143 UL: 90	Hi: 288 Me: 238 Lo: 163 UL: 103	Hi: 297 Me: 228 Lo: 182 UL: 103
Exterior dimensions (HxWxD)	mm	305x920x220				
Net weight	kg	13				
Clean filter	Liquid line	Allergen Clear Filter x 1, Photocatalytic Washable Deodorizing Filter x 1				
	Gas line	Ø6.35 (1/4")				
Piping		Ø9.52 (3/8")				
OUTDOOR UNITS TO BE COMBINED		SCM 40,45,50,60,71,80, 100ZS-W				
		Ø12.7 (1/2")				
		SCM 60,71,80,100ZS-W				

\* Operation data has been gathered in accordance with AS/NZS 3823 standards. For testing conditions please refer to Page 10. In case of SCM multi system, Allergen Clear control function is invalid and if Allergen Clear button is pressed, the indoor unit which received command will stop.

# SRK-ZRA & SRF-ZS(X)-W SERIES

SRK-ZRA-W			
CAPACITY		7.1kW	8.0kW
Model Number		SRK71ZRA-W	SRK80ZRA-W
Cooling capacity	kW	7.1	8.0
Heating capacity		8.0	9.0
*Sound power level	dB(A)	55	58
		59	61
*Sound pressure level	dB(A)	Hi: 43 Me: 40 Lo: 36 UL: 24	Hi: 46 Me: 43 Lo: 38 UL: 25
		Hi: 46 Me: 39 Lo: 35 UL: 28	Hi: 47 Me: 41 Lo: 36 UL: 29
		Hi: 342 Me: 310 Lo: 270 UL: 173	Hi: 383 Me: 345 Lo: 300 UL: 182
Airflow	Indoor	Hi: 425 Me: 330 Lo: 288 UL: 222	Hi: 450 Me: 363 Lo: 315 UL: 233
Exterior dimensions (HxWxD)	mm	339x1197x262	
Net weight	kg	15.5	
Clean Filter	Liquid line	Allergen Clear Filter x 1, Photocatalytic Washable Deodorizing Filter x 1	
	Gas line	Ø6.35 (1/4")	
Piping		Ø15.88 (5/8")	
OUTDOOR UNITS TO BE COMBINED		SCM71, 80,100ZS-W	
		SCM100ZS-W	

SRF-ZS(X)-W				
CAPACITY		2.5kW	3.5kW	5.0kW
Model		SRF25ZS-W	SRF35ZS-W	SRF50ZS(X)-W
Cooling capacity	kW	2.5	3.5	5.0
Heating capacity		3.4	4.5	5.8
*Sound power level	dB(A)	50	51	58
		51	52	58
*Sound pressure level	dB(A)	Hi: 38 Me: 32 Lo: 29 UL: 25	Hi: 40 Me: 35 Lo: 33 UL: 29	Hi: 46 Me: 38 Lo: 33 UL: 26
		Hi: 39 Me: 35 Lo: 33 UL: 29	Hi: 41 Me: 36 Lo: 35 UL: 33	Hi: 46 Me: 41 Lo: 38 UL: 32
		Hi: 150 Me: 127 Lo: 112 UL: 97	Hi: 168 Me: 130 Lo: 122 UL: 107	Hi: 192 Me: 160 Lo: 123 UL: 110
Airflow	Indoor	Hi: 175 Me: 137 Lo: 128 UL: 110	Hi: 178 Me: 138 Lo: 135 UL: 123	Hi: 200 Me: 167 Lo: 157 UL: 127
Exterior dimensions (HxWxD)	mm	600 x 860x 238		
Net weight	kg	18		
Piping	Liquid line	Ø6.35 (1/4")		
	Gas line	Ø9.52 (3/8")		
OUTDOOR UNITS TO BE COMBINED		SCM40,45,50,60,71,80,100ZS-W		
		SCM50,60,71,80,100ZS-W		

\* Operation data has been gathered in accordance with AS/NZS 3823 standards. For testing conditions please refer to Page 10. In case of SCM multi system, Allergen Clear control function is invalid and if Allergen Clear button is pressed, the indoor unit which received command will stop.

PRODUCT SPECIFICATIONS  
**SRR-ZS, FDTC-VH & FDUM SERIES**

SRR-ZS							
2.5kW		3.5kW		5.0kW		6.0kW	
SRR25ZS-W		SRR35ZS-W		SRR50ZS-W		SRR60ZS-W	
Model Number							
Cooling capacity	kW	2.5	3.5	5.0	6.0		
Heating capacity		3.4	4.5	5.8	6.8		
	dB(A)	56	57	59	60		
*Sound power level		59	60	61	63		
	dB(A)	Hi: 37 Me: 33 Lo: 30 ULo: 24 Hi: 40 Me: 37 Lo: 34 ULo: 28	Hi: 38 Me: 34 Lo: 31 ULo: 25 Hi: 42 Me: 38 Lo: 35 ULo: 29	Hi: 41 Me: 37 Lo: 34 ULo: 29 Hi: 43 Me: 39 Lo: 37 ULo: 32	Hi: 44 Me: 38 Lo: 35 ULo: 30 Hi: 45 Me: 41 Lo: 38 ULo: 33		
*Sound pressure level	I/s	Hi: 158 Me: 133 Lo: 108 ULo: 75 Hi: 167 Me: 150 Lo: 133 ULo: 100	Hi: 167 Me: 142 Lo: 117 ULo: 83	Hi: 225 Me: 183 Lo: 167 ULo: 125	Hi: 242 Me: 192 Lo: 175 ULo: 133		
Airflow	Indoor	Hi: 167 Me: 150 Lo: 133 ULo: 100	Hi: 175 Me: 158 Lo: 142 ULo: 108	Hi: 233 Me: 208 Lo: 183 ULo: 142	Hi: 250 Me: 217 Lo: 192 ULo: 150		
Exterior dimensions (HxWxD)	mm	200x750x500					
Net weight	kg	20.5					
Clean Filter			Built-in				
	Liquid line		Ø6.35 (1/4")				
	Gas line						
Piping			Ø9.52 (3/8")				
OUTDOOR UNITS TO BE COMBINED		SCM40,45,50,60,71,80,100ZS-W		SCM50,60,71,80,100ZS-W		SCM60,71,80,100ZS-W	

FDTC-VH							
2.5kW		3.5kW		5.0kW		6.0kW	
FDTC25VH1		FDTC35VH1		FDTC50VH		FDTC60VH	
Model							
Cooling capacity	kW	2.5	3.5	5.0	6		
Heating capacity		3.4	4.5	5.8	6.8		
	dB(A)	51	52	59	60		
*Sound power level		52	54	59	60		
	dB(A)	P-Hi:38 Hi:34 Me:30 Lo:27 P-Hi:39 Hi:36 Me:32 Lo:29	P-Hi:39 Hi:36 Me:32 Lo:29 P-Hi:41 Hi:38 Me:34 Lo:30	P-Hi:44 Hi:40 Me:35 Lo:27 P-Hi:46 Hi:42 Me:38 Lo:31	P-Hi:46 Hi:42 Me:38 Lo:31 P-Hi:48 Hi:44 Me:40 Lo:33		
*Sound pressure level	I/s	P-Hi:142 Hi:125 Me:117 Lo:100 P-Hi:158 Hi:142 Me:125 Lo:108	P-Hi:150 Hi:133 Me:125 Lo:108 P-Hi:167 Hi:150 Me:133 Lo:117	P-Hi:217 Hi:183 Me:150 Lo:117 P-Hi:233 Hi:200 Me:167 Lo:133	P-Hi:233 Hi:200 Me:167 Lo:133 P-Hi:250 Hi:217 Me:183 Lo:142		
Airflow	Indoor	P-Hi:142 Hi:125 Me:117 Lo:100 P-Hi:158 Hi:142 Me:125 Lo:108	P-Hi:167 Hi:150 Me:133 Lo:117 P-Hi:183 Hi:167 Me:142 Lo:108	P-Hi:217 Hi:183 Me:150 Lo:117 P-Hi:233 Hi:200 Me:167 Lo:133	P-Hi:233 Hi:200 Me:167 Lo:133 P-Hi:250 Hi:217 Me:183 Lo:142		
Exterior dimensions (HxWxD)	mm	Unit: 248x570x570 / Panel: 10x620x620 TC-PSAE-5AW-E (Honey, comb) & TC-PSAGE-5AW-E (Grid)					
Net weight	kg	Unit: 13.5kg / Panel: 2.5kg	Unit: 14kg / Panel: 2.5kg				
Piping		Ø6.35 (1/4")	Ø6.35 (1/4")				
	Liquid line	Ø9.52 (3/8")	Ø12.7 (1/2")				
	Gas line						
Optional Parts		OA spacer : TC-OAS-E2, TC-OAD-E, Motion sensor : LB-TC-5W-E					
OUTDOOR UNITS TO BE COMBINED		SCM40,45,50,60,71,80,100ZS-W	SCM50,60,71,80,100ZS-W	SCM60,71,80,100ZS-W			

\* Operation data has been gathered in accordance with AS/NZS 3823 standards. For testing conditions please refer to Page 10. In case of SCM multi system, Allergen Clear control function is invalid and if Allergen Clear button is pressed, the indoor unit which received command will stop.

**Notes**



# THE EXPERTS IN AIR

[mhiaa.com.au](http://mhiaa.com.au)

ABN 92 133 980 275

**Australia:**

Phone: **1300 138 007**

**NSW & Head Office**

Block E, 391 Park Road, Regents Park NSW 2143

**Victoria**

2/15 Howleys Road, Notting Hill VIC 3168

**Brisbane**

5/26 Flinders Parade, North Lakes QLD 4509

**Adelaide**

T50 Innovation House, Mawsons Lakes Boulevard, Mawsons Lakes SA 5095

**Townsville**

1/37 Ross River Road, Mysterton QLD 4812

**Western Australia**

1/15-17 Capital Road, Malaga WA 6090

Mitsubishi Heavy Industries Air conditioners Australia, Pty. Ltd.

MOVE THE WORLD FORWARD  **RD** **MITSUBISHI  
HEAVY  
INDUSTRIES  
GROUP**